

Stock Code: **20292-WH/FST**

Collection: Nauticus Dual Mount

**PRODUCT INFORMATION**

Base: 20292 Parent: 20292  
Mounting Type: Ceiling or Wall UPC: 641594001334  
Finish: White  
Diffuser: Frosted

**PRODUCT MEASUREMENTS**

<b>FIXTURE</b>	<b>BACKPLATE / CANOPY</b>
Length:	Length 10.75"
Width: 11"	Width: 6.5"
Diameter	Diameter:
Height: 6.5"	Height: 1"
Extension: 5"	
Overall Height:	

**TECHNICAL SPECIFICATIONS**

**SPECIFICATIONS**

Frame Material: Aluminum	
Diffuser Material: Glass	
Lamping Type: E-26 (Incandescent)	Jbox: Standard
Lamping Base: E-26	Lamp Wattage: 100 W
Lamp Quantity: 1	Total Wattage: 100 W
Voltage: 120v	Lamps Included: No

**QUALIFICATIONS**

Location Rating: Wet	
Certification: UL (US/Canada) Listed	
ADA Compliant: No	Energy Star: No
JA8 Compliant: No	Emergency Lighting: No
Marine Grade: No	Warranty: 1 Year

**PHOTOMETRICS**

Dimmable: Yes	Nominal Lumens: N/A
CRI: N/A	Delivered Lumens: N/A
CCT: N/A	
Recommended Dimmers: (TRIAC)Any Standard Dimmer	

Additional Notes:  
Custom Finish 5 Piece Minimum Order Quantity

Project Name: \_\_\_\_\_  
 Location: \_\_\_\_\_  
 Type: \_\_\_\_\_  
 Quantity: \_\_\_\_\_  
 Notes: \_\_\_\_\_



LINE DRAWING

IES FILE

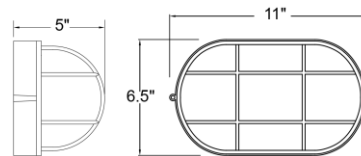

In addition to Access Lighting's purchase and warranty terms and conditions, by signing below or placing an order, you agree that you are authorized to bind the entity placing any order and acknowledge the following: All of sizes and measurements are approximate and all images are for illustrative purposes only. In the event of an inconsistency, the "Product Measurements" section controls. There also may be slight differences in the colors and designs compared to the displayed and printed images.

Signature: \_\_\_\_\_

Print Name \_\_\_\_\_ Date: \_\_\_\_\_

**Toll Free 800-828-5483 www.AccessLighting.com**

14410 Myford Road, Irvine, CA 92606

